



# 3000 Series Tri-Style

Non Handed Door Closer



## Installation Instructions

80-9303-2206-010 (04-09)



CAUTION

An Incorrectly installed or improperly adjusted door closer can cause property damage or personal injury. These installation instructions should be followed to avoid the possibility of misapplication or misadjustment.

CAUTION

## Non Hold Open Models

Sized  
(Sizes 2,3,4,5,6)

3100  
3300  
3500

Adjustable  
(Sizes 1 thru 6)

3301  
3501

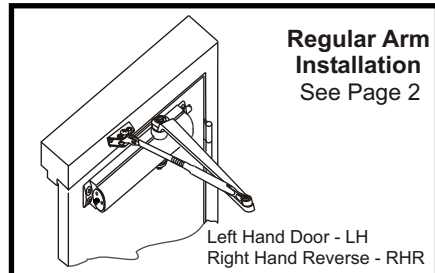

**Regular Arm Installation**  
See Page 2

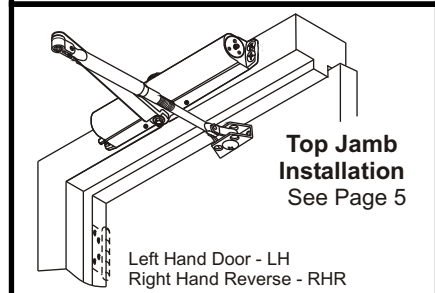

**Top Jamb Installation**  
See Page 5

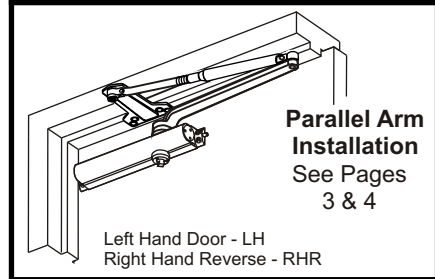

**Parallel Arm Installation**  
See Pages 3 & 4

"DL" suffix (Delayed Action) is an optional feature.

**NOTE:** For special applications a separate door and frame preparation template is packed with these instructions. Use this instruction sheet for installation sequence and closer adjustments only.

- Doors should be hung on ball bearing or anti-friction hinges.
- A separate door stop is recommended.
- Door and frame must be properly reinforced.
- Always adjust spring power before adjusting control.
- Adjust closing time speed between 3 and 7 seconds from 90° to 0°. Greater closing times may be required for elderly or handicapped.
- These door closers should NOT be installed on the exposed side (weather side) of exterior doors.

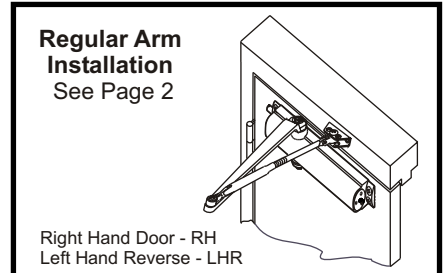

**Regular Arm Installation**  
See Page 2

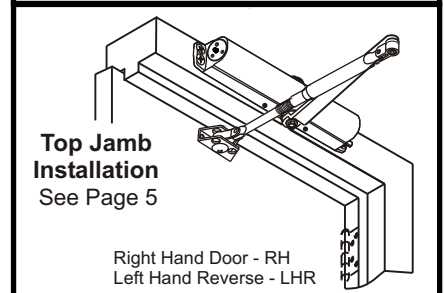

**Top Jamb Installation**  
See Page 5

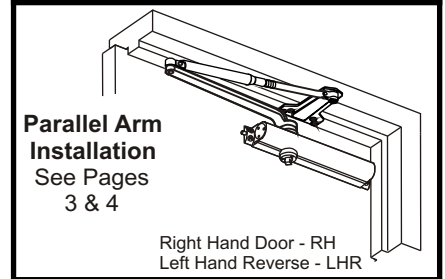

**Parallel Arm Installation**  
See Pages 3 & 4

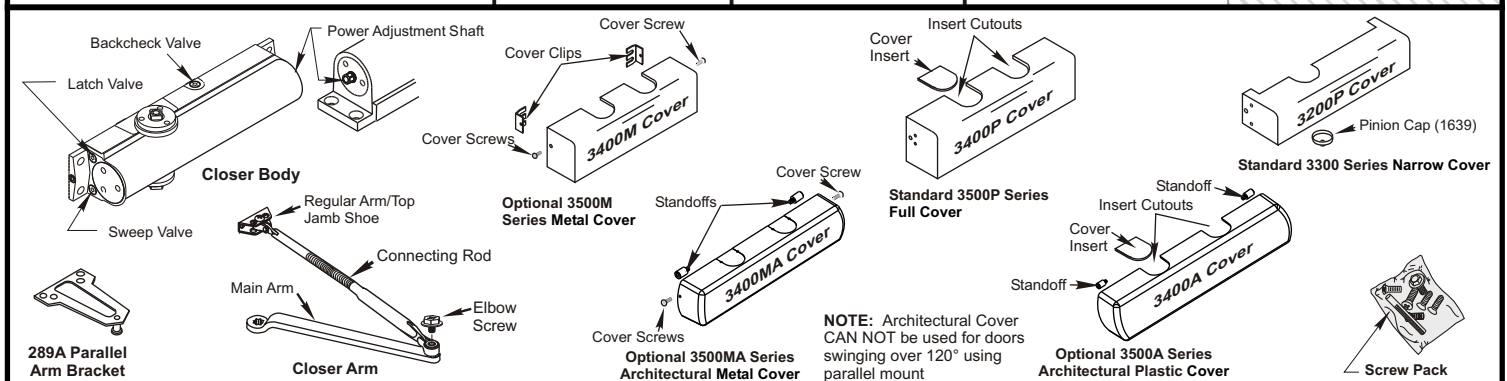
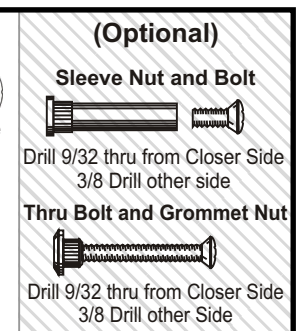
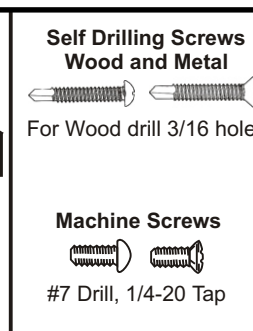
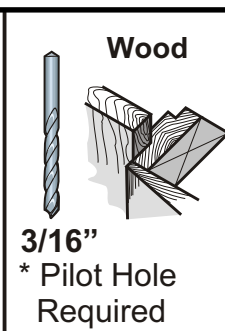
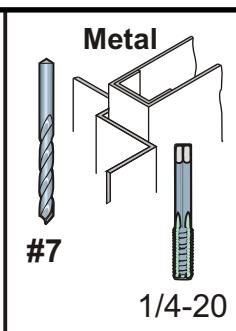
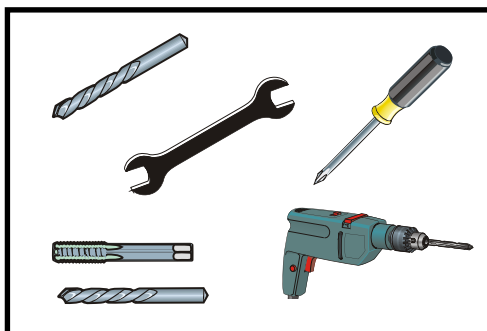

# 3000 Series

## Non Hold Open Door Closers — Regular Arm

80-9303-2206-010 (04-09)

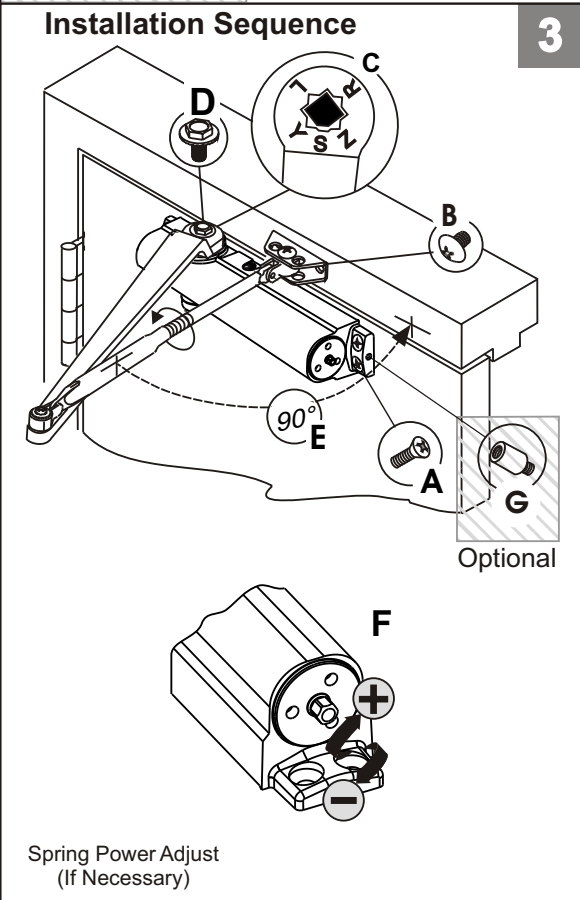
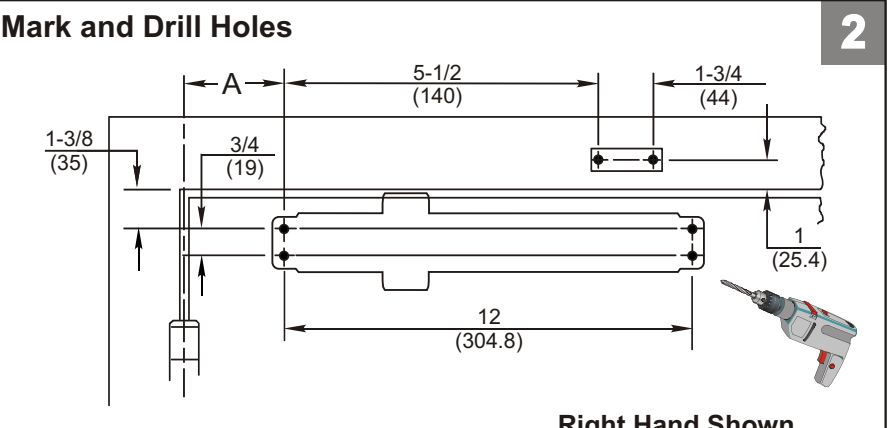
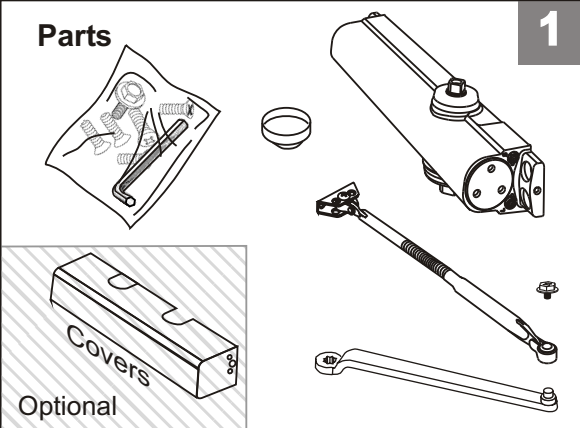

Opening	Dimension "A"	Inches (mm)
To 100°	7-1/2 (191)	
101° to 130°	6 (152)	
131° to *180°	4-1/2 (114)	

\* Door/Wall/Hardware/Jamb conditions permitting

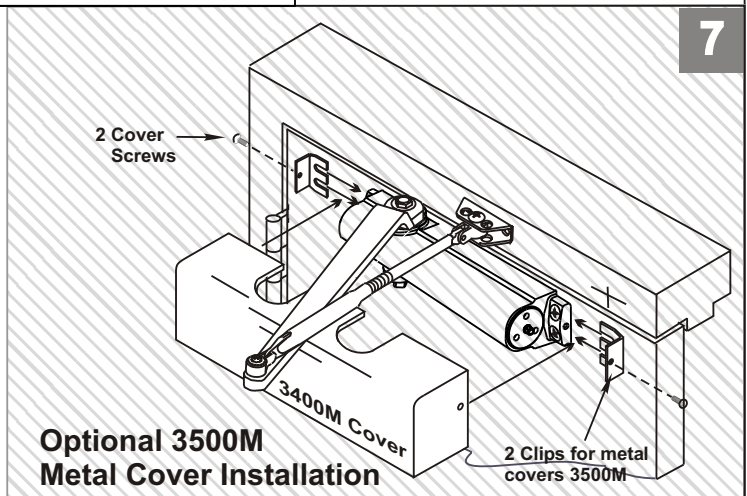
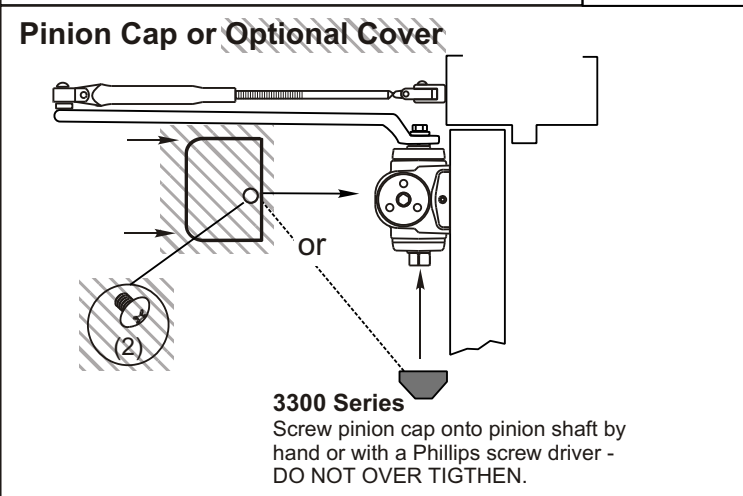
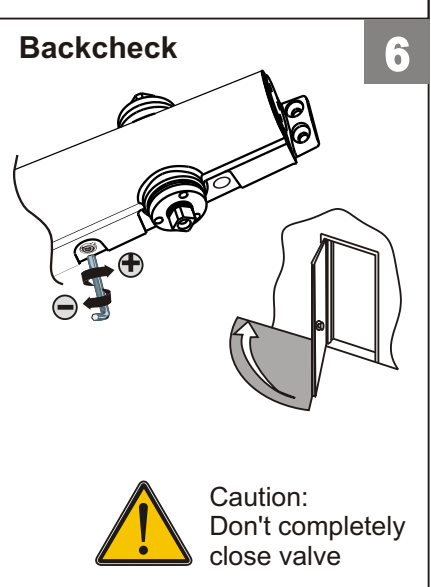
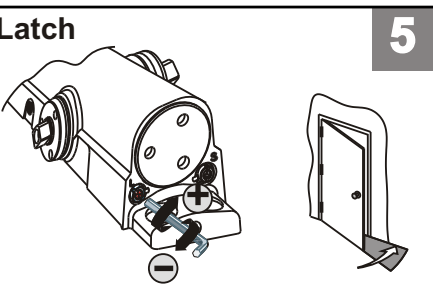
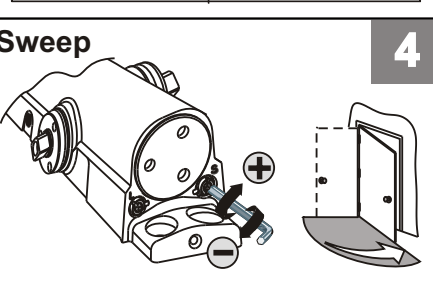

# 3000 Series

## Non Hold Open Door Closers — Parallel Arm

80-9303-2206-010 (04-09)

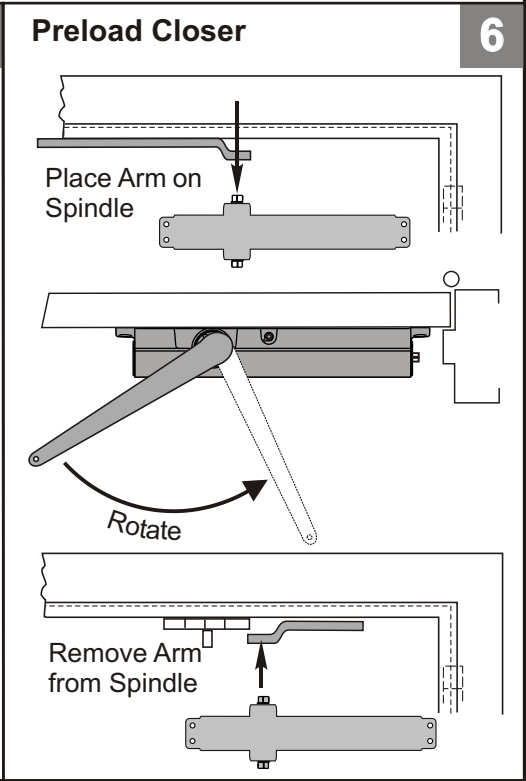
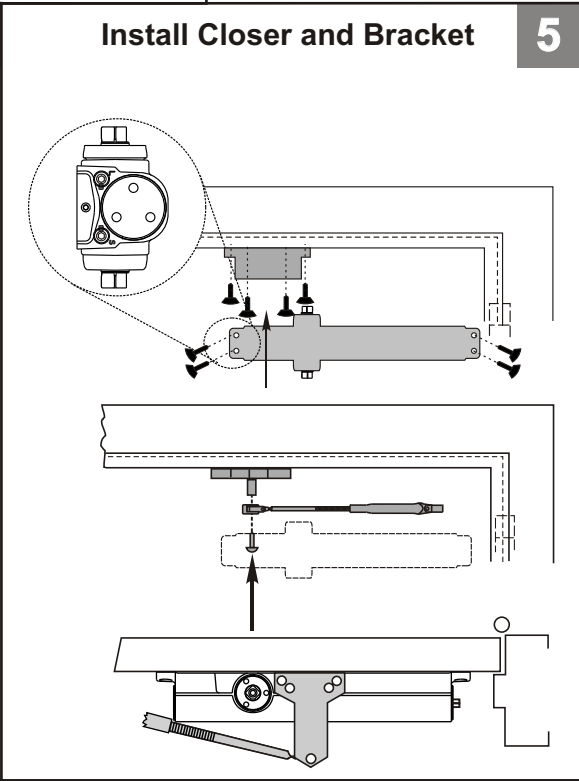
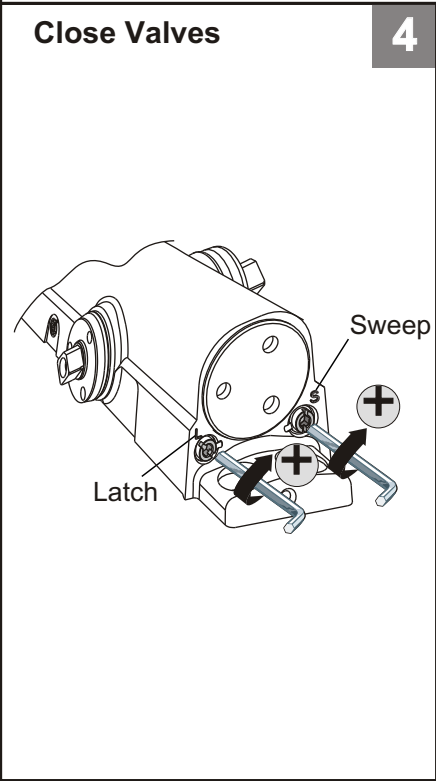
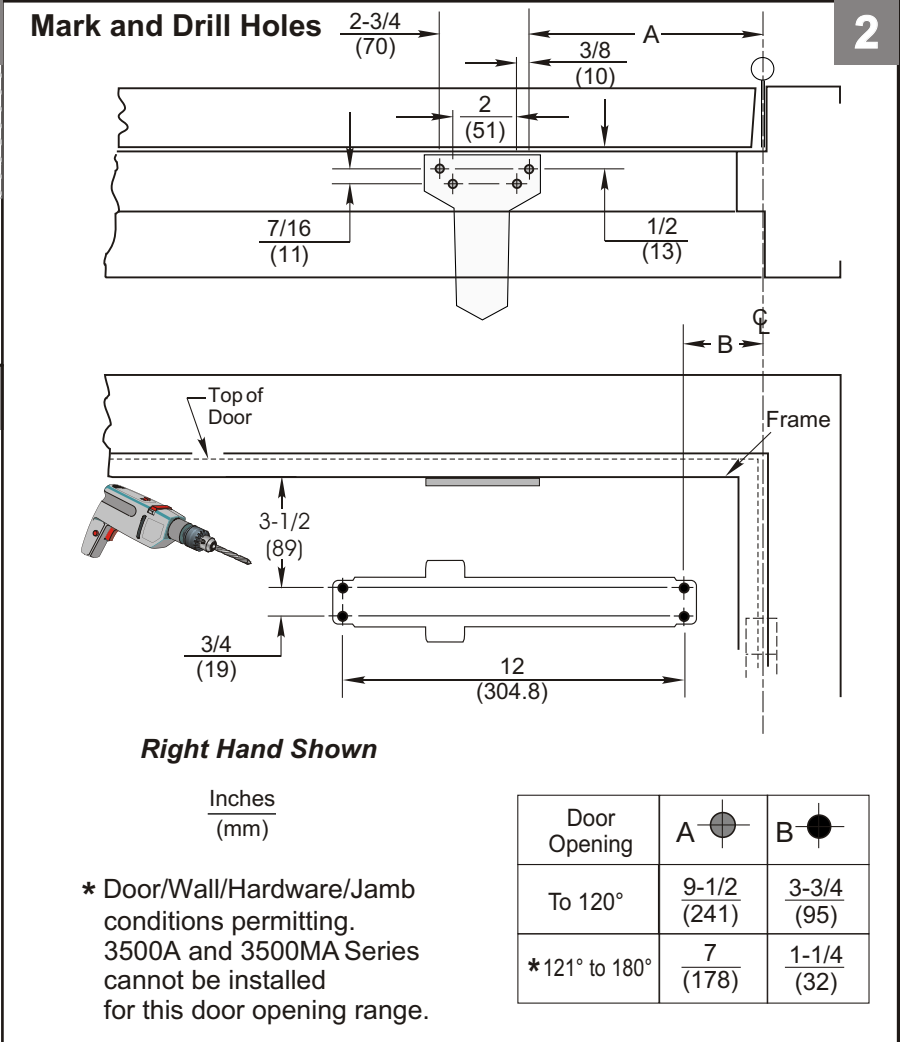
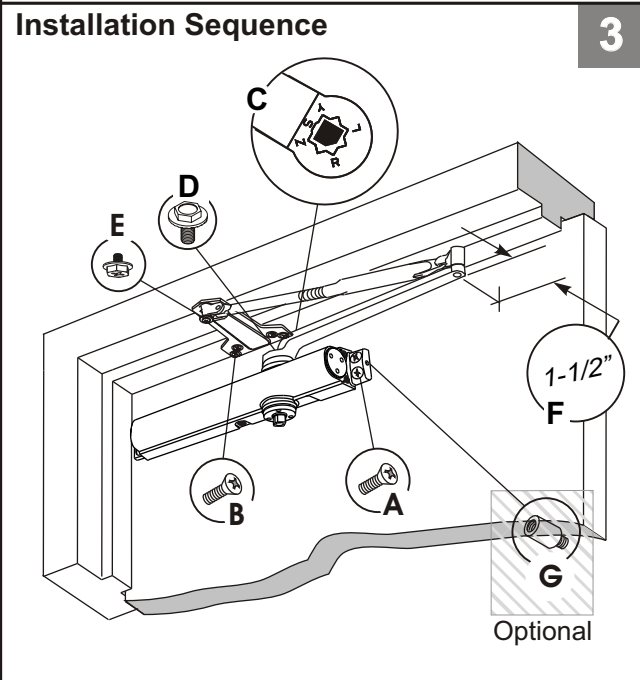
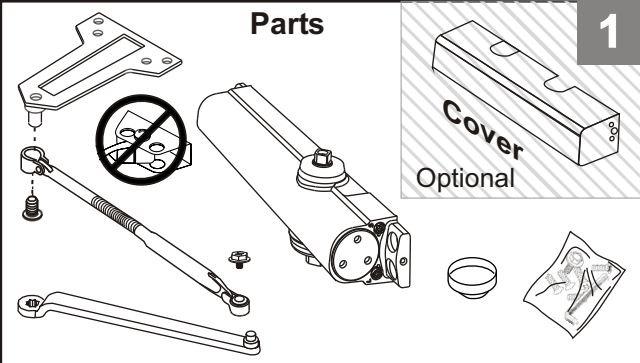

# 3000 Series

## Non Hold Open Door Closers — Parallel Arm

80-9303-2206-010 (04-09)

7

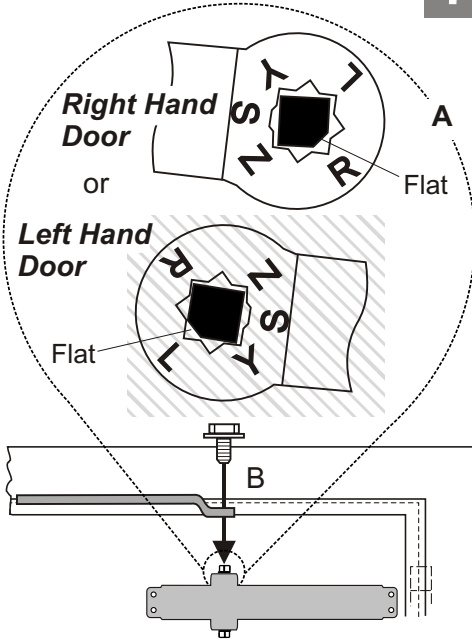

### Open Valves

8

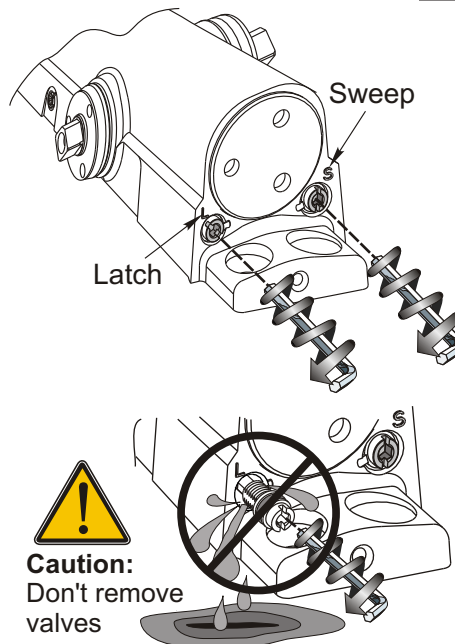

### Assemble Arm

9

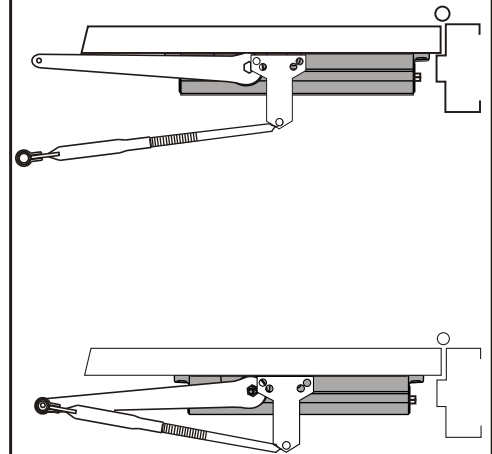

### Arm Screw

10

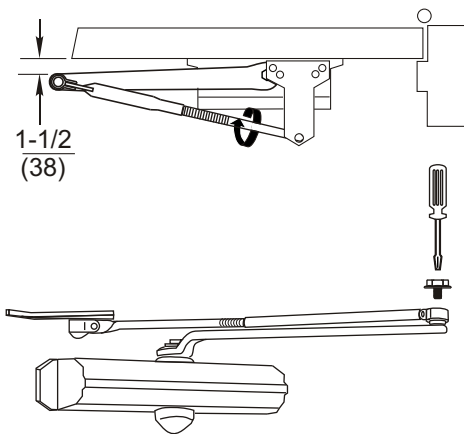

### Spring Power Adjust (If necessary)

11

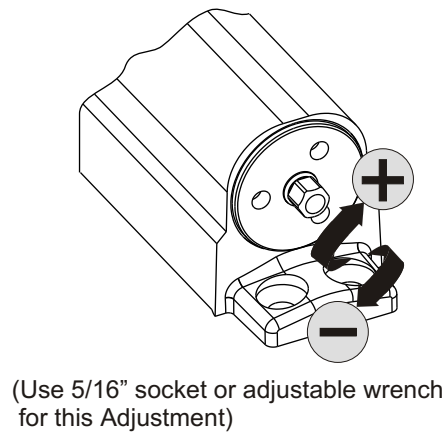

### Sweep

12

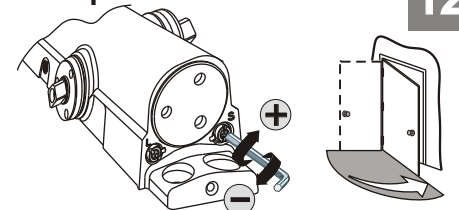

### Latch

13

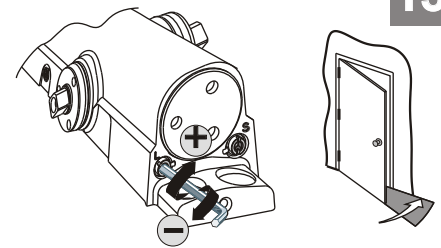

### Backcheck

14

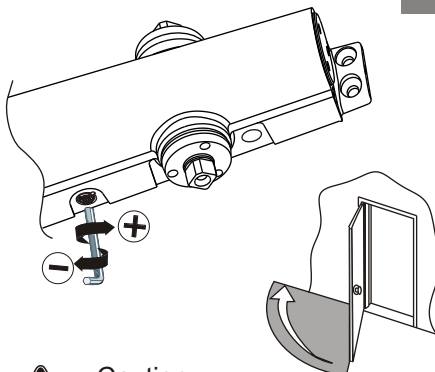

Caution:  
Don't completely  
close valve

### Pinion Cap or Optional Cover

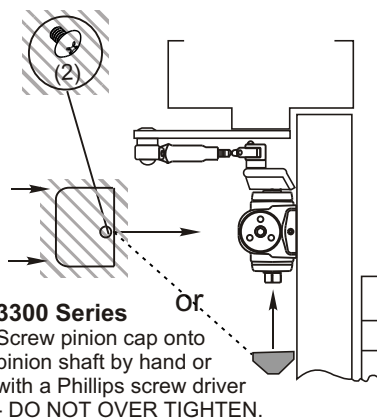

### Optional 3500M Metal Cover Installation

15

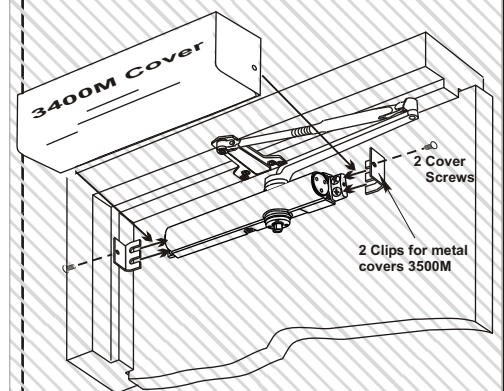



# 3000 Series

## Non Hold Open Door Closers — Top Jamb Arm

80-9303-2206-010 (04-09)

### Parts

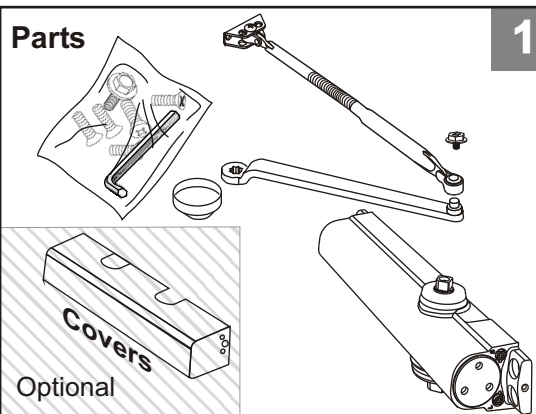

1

### Mark and Drill Holes

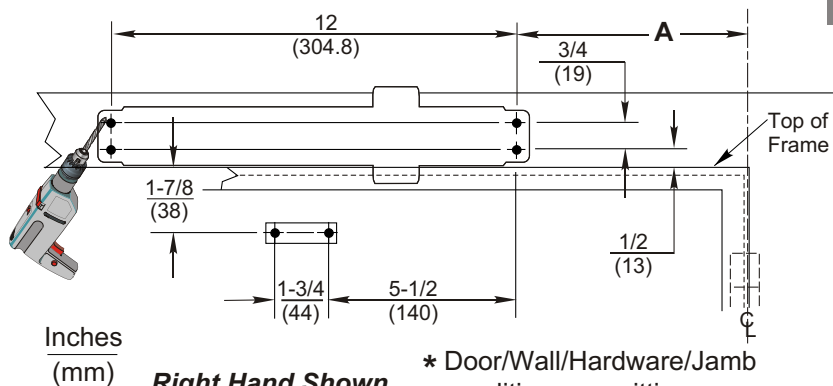

2

### Installation Sequence

3

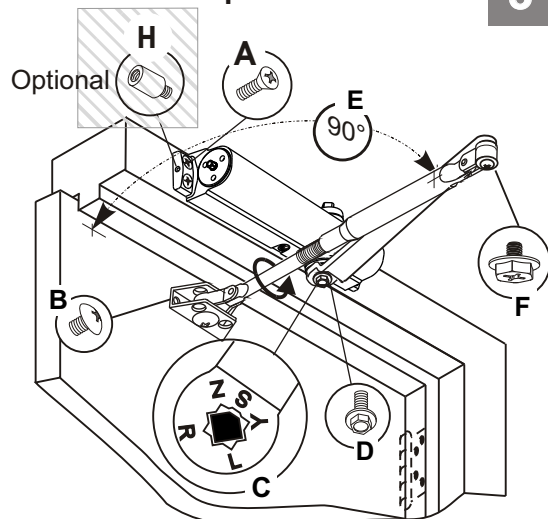

Opening	Dimension "A"
To 100°	7-1/2 (191)
101° to 130°	6 (152)
131° to *180°	4-1/2 (114)

A longer connecting rod, 400-11A, is required for reveals greater than 3" (76)

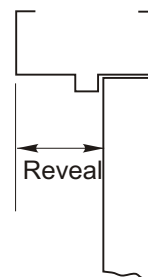

### Sweep

4

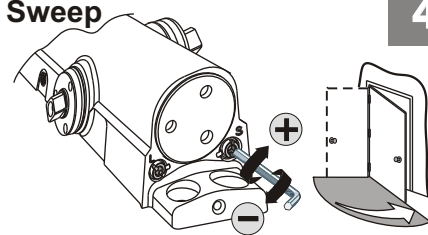

### Latch

5

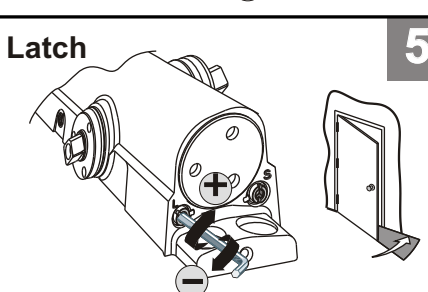

### Backcheck

6

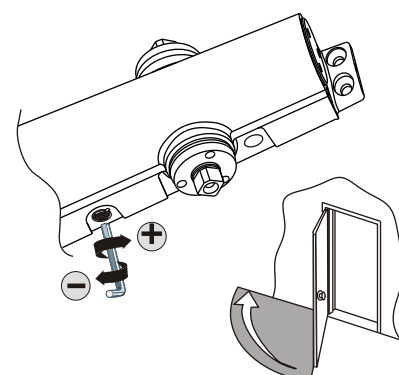

Caution: Don't completely close valve

Spring Power Adjust (If Necessary)

### Pinion Cap or Optional Cover

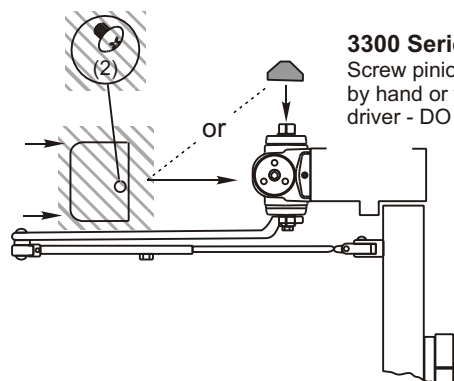

### Optional 3500M Metal Cover Installation

7

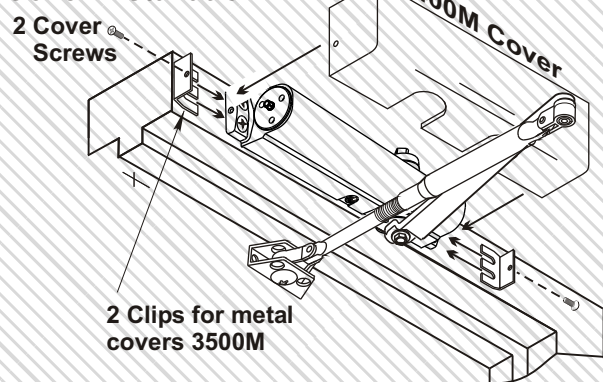

# 3000 Series

80-9303-2206-010 (04-09)

**Yale**

An ASSA ABLOY Group brand

3000 Highway 74 East • Monroe, NC 28112  
Tel: (800)-438-1951 • Fax: (800)-3380965  
www.yalecommercial.com

Yale® is a registered trademark of Yale Security Inc., an ASSA ABLOY Group company.  
Copyright © 2004, 2008, Yale Security Inc., an ASSA ABLOY Group company. All rights reserved.  
Reproduction in whole or in part without the express written permission of Yale Security Inc. is prohibited.

(Use 1/8" Hex Wrench for these Adjustments)

## Delayed Action (Optional)

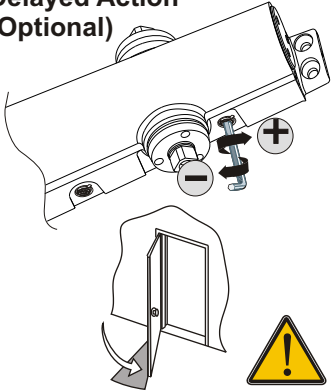

## Sweep

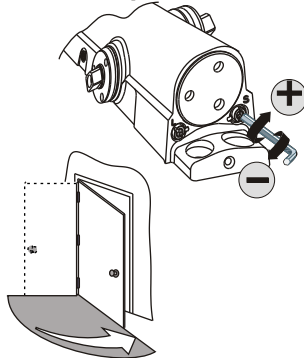

## Latch

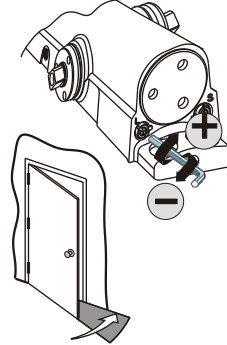

## Backcheck

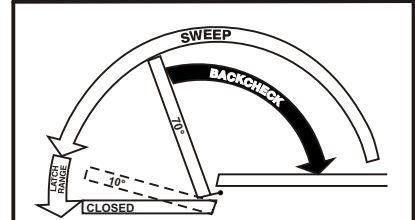
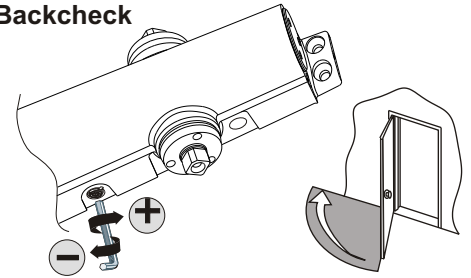

**Adjust Closing Speed Time to between 3 to 7 seconds from 90°.**  
Use of the door by handicapped, elderly or small children may require greater closing time.

## Spring Power Adjust

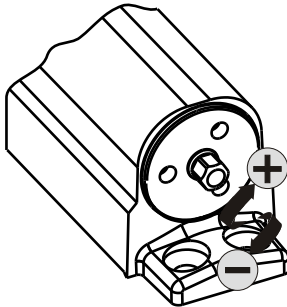

(Use 5/16" socket or adjustable wrench for this Adjustment)

## Adjustment Chart (3301 & 3501 Only)

Number of Turns Required  
MAXIMUM DOOR SIZE

	DOOR	TYPE OF INST.	*	32" (0.85M)	36" (0.90M)	42" (1.00M)	48" (1.20M)
3100/3300/3500	INTERIOR	Regular Arm Top Jamb	FULL 360° TURNS OF 5/16 POWER ADJUSTMENT WRENCH	5	8	11	13
		Parallel Arm		7	10	13	16
	EXTERIOR	Regular Arm Top Jamb		7	10	13	16
		Parallel Arm		9	12	15	18

\*20 FULL (360°) TURNS MAXIMUM AVAILABLE  
Closer is shipped set at mid range setting = 10 turns



The closing force for series 3301 & 3501 door closers is adjustable from a size 1 to a size 6, as outlined in ANSI Standard A156.4. When these series of door closers are installed and adjusted to conform to ADA reduced opening force requirements (5 lbs max.) for interior doors, they may not have adequate closing force to reliably close and latch the door. Power adjustments charted on this page are recommended where possible, to ensure proper door control.



By law the Americans with Disabilities Act (ADA) may require that door closer installation comply with accessibility guidelines.

## To identify your model:

**Closer Size**  
Blank = 3301/3501  
2 = 3302/3502  
3 = 3303/3503  
4 = 3304/3504  
5 = 3305/3505  
6 = 3306/3506

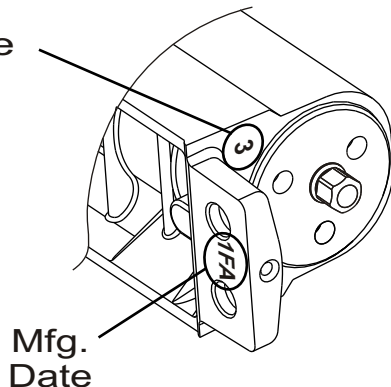

## Arm Placement in Shoe

